



5.2L I4 TURBOCHARGED
215 HP @ 2,500 RPM
452 LB-FT @ 1,850 RPM

NPR-HD

14,500 LBS. GVWR
CLASS 4



BODY PAYLOAD



20,500 lbs. GCWR
TRUCK WEIGHT & TRAILER WEIGHT



30-GAL. IN-FRAME
FUEL TANK

BRAKES
VACUUM/HYDRAULIC
WITH 4-CHANNEL ABS

Front Disc
11.5 in.

Rear Disc
11.5 in.

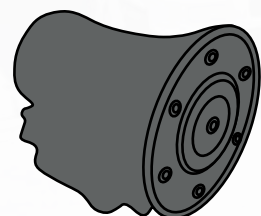
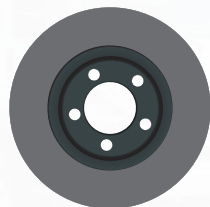
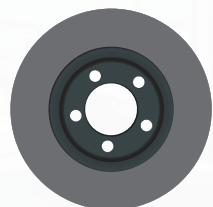

6-SPEED AUTOMATIC
TRANSMISSION



215/85R16E (10-pr)
TIRES



STANDARD CAB / CREW CAB
SEATING FOR UP TO 3 / SEATING FOR UP TO 7